

# TCHR-30-110C

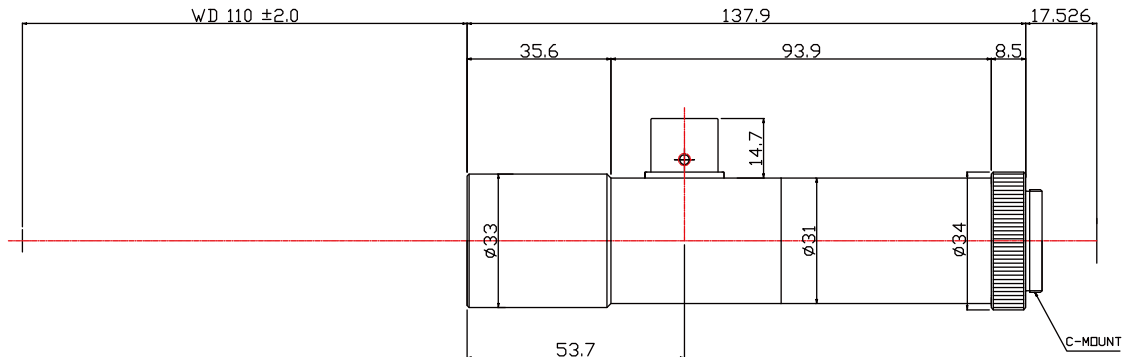

The Object Side Telecentric Lens TCHR-30-110C is suitable for sensors with an image format of 2/3 inch.

## Technical Data

Art.Gr.	TEL
Magnification	3 X
Working Distance (WD)	110 mm
Depth of Field (DOF)	148 $\mu\text{m}$ @CoC 40 $\mu\text{m}$
Resolution (Object Side)	3.7 $\mu\text{m}$
Image Format (max.)	2/3 inch
Working F-Number	16.6
Numerical Aperture (NA)	0.09
Field of View (FOV)	2.93mm x 2.2mm @ 2/3"
Telecentric Type	Object Side
Telecentricity	0.02 °
Optical Distortion (max.)	0.11 %
Mount Type	C-Mount

